

HOUSE PANELBOARD PB-F SCHEDULE					
ITE EQ 430B 120/208V 3P 4-W SN 200 AMP M.L.O. 30-SPACES FL. MOUNT					
CIRCUIT	VOLTS	POLES	BKR	WIRE	PURPOSE
F-1	120	1	20A	#12	EQUIPMENT RM
F-2	"	"	"	"	REC. RM. DECEPT
F-3	"	"	"	"	WATER COOLER
F-4	"	"	"	"	REC. RM. LIGHTS
F-5	"	"	"	"	REC. RM. LIGHTS
F-6	"	"	"	"	CARD RM DECEPT
F-7	"	"	"	"	CARD RM LIGHTS
F-8	"	"	"	"	REC. RM. TOILETS
F-9	208	3	50A	#6	REC. RM. HTR
F-10	"	2	15A	#12	REC RM A.H.
F-11	"	3	50A	#8 THW	REC. RM. A.C.
F-12	120	1	20A	#10	OUTSIDE RECEPT.
F-13	"	"	"	"	"
F-14	"	"	"	"	"
F-15	"	"	"	"	"
F-16	"	"	"	#12	ELEV. P.T
F-18	"	"	"	"	TELEPHONE EQUIP.

- NOTES:
1. ALL CONDUCTORS TO BE COPPER. ALUMINUM IS NOT ACCEPTABLE.
 2. NO MORE THAN 3 CONDUCTORS TO BE RUN IN A SINGLE CONDUIT WITHOUT INCREASING WIRE SIZE TO OFFSET DERATING FACTOR.

ELECTRICAL LEGEND	
MARK	DESCRIPTION
⊕	120V GROUNDED DUPLEX RECEPTACLE 15AMP
⊕ WP	120V WEATHERPROOF GROUNDED DUPLEX RECEPTACLE 15AMP
⊕	120V 15AMP TOGGLE SWITCH
⊕	120V 15AMP 3WAY TOGGLE SWITCH
⊕	50 AMP, 208V OUTLET WITH PIGTAIL
⊕	30 AMP, 208V OUTLET WITH PIGTAIL
⊕	WALL BRACKET FIXTURE
⊕	CEILING FIXTURE SURFACE MOUNT
⊕	CEILING FIXTURE RECESSED
⊕	2 LAMP FLUORESCENT FIXTURE
⊕	VAPOR PROOF FIXTURE
⊕ VP	TELEPHONE OUTLET
⊕ TV	TELEVISION OUTLET
⊕	CONTROLLER
⊕	DISCONNECT SWITCH
⊕	DISPOSAL FURNISHED BY OTHERS
⊕	FAN FURNISHED BY OTHERS
⊕	MOTOR FURNISHED BY OTHERS
⊕	ELECTRICAL PANEL
J.B.	JUNCTION BOX
⊕	NOTONE 9401 250W. HEAT LAMP

HOUSE PANELBOARD PB-H SCHEDULE					
ITE EQ 16 120/208V 2P 3W SN 125A M.L.O. 16-1P SPACES. FLUSH MOUNT					
CIRCUIT	VOLTS	POLES	BKR	WIRE	PURPOSE
H-1	120	1	15A	#12	WALK LIGHTS
H-2	"	"	"	"	"
H-3	"	"	"	"	"
H-4	"	"	"	"	"
H-5	"	"	"	"	"
H-6	"	"	20A	"	E-W ENTRY
H-7	"	"	"	"	NORTH ENTRY
H-8	"	"	"	"	CANOPY
H-9	"	"	"	#10	PARKING

- NOTES:
1. ALL CONDUCTORS TO BE COPPER. ALUMINUM IS NOT ACCEPTABLE.
 2. NO MORE THAN 3 CONDUCTORS TO BE RUN IN A SINGLE CONDUIT WITHOUT INCREASING WIRE SIZE TO OFFSET DERATING FACTOR.

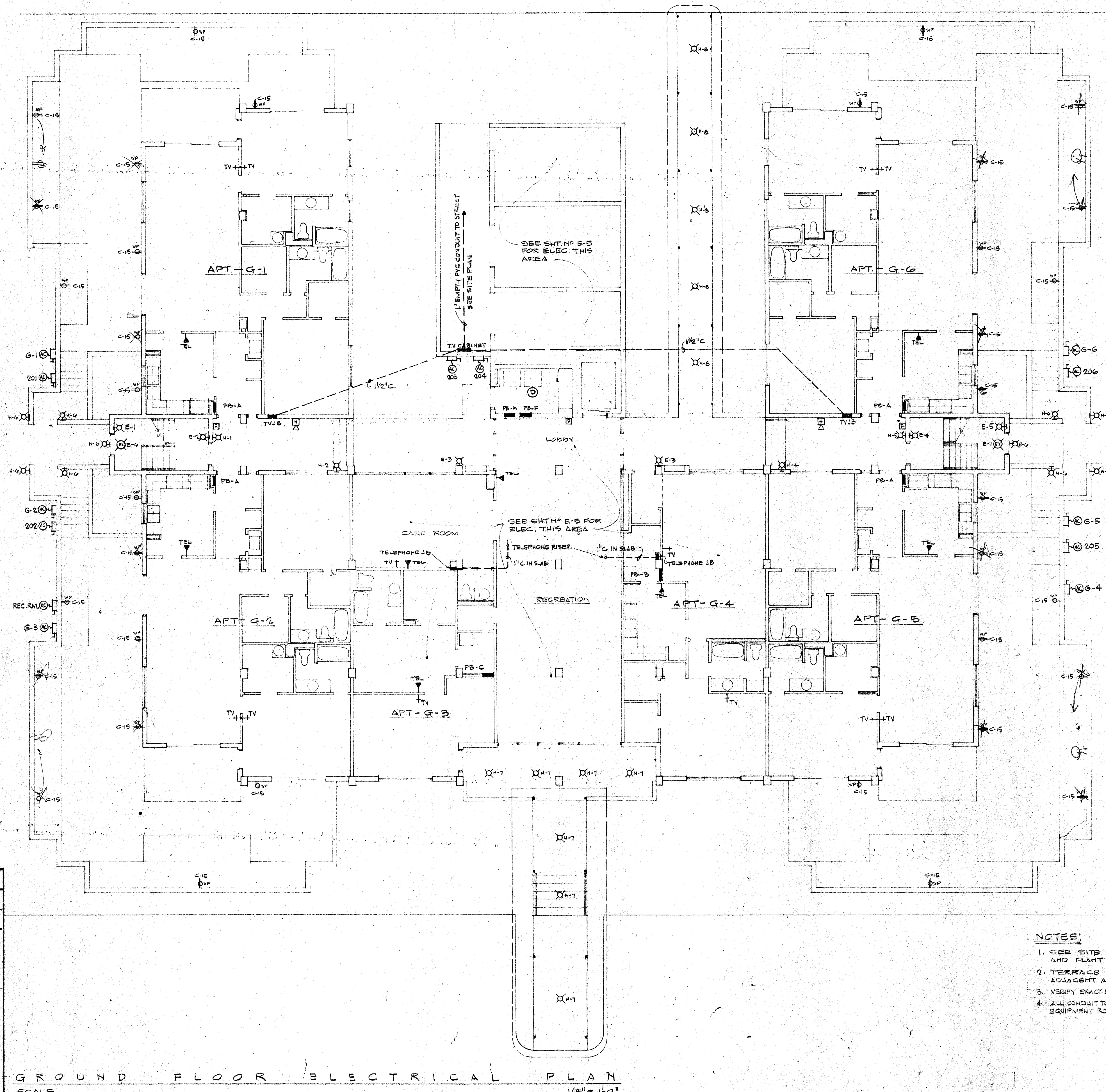

GROUND FLOOR ELECTRICAL PLAN
SCALE 1/8" = 1'-0"

- NOTES:
1. SEE SITE PLAN SHT NO A-1 FOR GROUND AND PLANT LIGHTING.
 2. TERRACE CIRCUIT C-15 TO CONNECT TO ADJACENT APT. PB-A ON APTS. G-1, G-2, G-5, G-6.
 3. VERIFY EXACT LOCATION OF A/C UNITS WITH HV&AC CONTRACTOR.
 4. ALL CONDUIT TO BE RUN CONCEALED EXCEPT IN MECHANICAL EQUIPMENT ROOM AND ELEVATOR MACHINE ROOM.